

RUB

Rubinetto scarica mandrino
Drain valve



Caratteristiche tecniche / Technical specifications

Materiale / Material	Ottone / Brass
Temperatura di esercizio <i>Working temperature</i>	-40° C +120° C
Massima pressione di esercizio <i>Max. working pressure</i>	260 bar

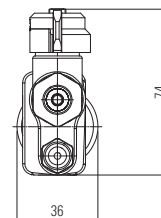
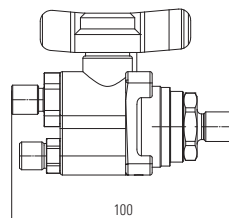

Codifica / Part n°
RUB XO. NGV1 T

ATTACCHI / CONNECTIONS

X: n° di attacchi / n° of connections
O: 1/4" GAS

MANDRINO / FILLING NOZZLE

NN: Senza mandrino / Without filling nozzle
NGV1: Con mandrino per carica NGV1-P30 / With CNG filling nozze NGV1-P30
MI: Con mandrino Italia / With Italian filling nozzle
ME: Con mandrino estero / With foreign filling nozzle

TUBO / PIPE

N: Senza tubo / Without pipe
T: Con tubo flessibile alta pressione / With high pressure flexible pipe

Alcune versioni disponibili / Some available part n°

Attacchi <i>Connections</i>	Mandrino <i>Filling nozzle</i>	Tubo / Pipe	Codice Emer <i>Emer part n°</i>	Codice Emer obsoleto <i>Former Emer part n°</i>
2 x 1/4" GAS	Mandrino Italia / Italian filling nozzle	-	RUB20.MIN	RUB401
	Mandrino estero / Foreign filling nozzle	-	RUB20.MEN	RUB402
	-	-	RUB20.NNN	RUB404
	NGV1-P30	✓	RUB20.NGV1T	RUB405
3 x 1/4" GAS	-	-	RUB20.NGV1N	RUB406
	-	-	RUB30.NNN	RUB403

www.emer.it

Emer S.p.A.
Via Giovanni Bormioli 19
25135 – Brescia
Italy
Tel +39 030 2510391
Fax +39 030 2510392
commercial@emer.it

SISTEMI DI CARICA
MANDRINI E RUBINETTI METANO
CNG FILLING SYSTEMS
NOZZLES AND DRAIN VALVES



RUBL

Rubinetto in linea
CNG in-line nozzle



Caratteristiche tecniche / Technical specifications

Materiale / Material	Ottone / Brass
Temperatura di esercizio / Working temperature	-40° C +120° C
Massima pressione di esercizio / Max. working pressure	220 bar
Sezione minima di passaggio del gas / Minimum gas flowing area	Ø 10 mm
Omologazione / Approval	ECE 110

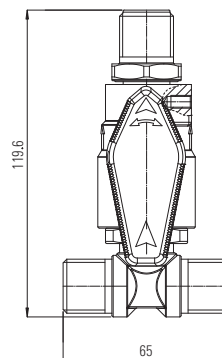
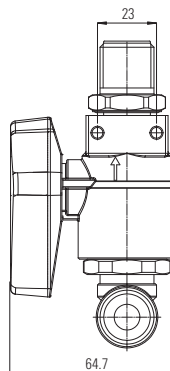

Codifica / Part n°

RUBL XT. N T O

ATTACCHI / CONNECTIONS

- X:** n° attacchi / n° of connections
- T:** 1/2" GAS M
- 6:** Per tubo Ø 16 mm / For Ø 16 mm pipe
- S:** 1/2" GAS F
- U:** 1/2" GAS F e / and 1/2" GAS M

POSIZIONE DEL RACCORDO A "T" / "T" CONNECTION POSITION

- N:** T non presente / Without T
- I:** T in ingresso / Input T connection
- U:** T in uscita / Output T connection

ACCESSORI / DEVICES

- N:** Nessuno / None
- T:** Tappi / Caps
- S:** Staffa / Bracket
- W:** Tappi e staffa / Caps and bracket
- I:** Innesto / Receptacle NGV1-P30

MATERIALE VOLANTINO / HANDWHEEL MATERIAL

- L:** Alluminio / Aluminum
- O:** Ottone / Brass

Alcune versioni disponibili / Some available part n°

Attacchi / Connections	Raccordo a T / T connection	Accessori / Devices	Codice Emer / Emer part n°	Codice Emer obsoleto / Former Emer part n°
2 x tubo / Pipe Ø 16 mm	-	Tappi / Caps	RUBL26.NTO	RUBL450
		Tappi + staffa / Caps and bracket	RUBL26.NWO	RUBL470
2 x 1/2" GAS F	-	Tappi / Caps	RUBL2S.NTO	RUBL450/A
1 x 1/2" GAS M 1 x 1/2" GAS F	-	Tappi / Caps	RUBL2U.NTO	RUBL465
1 x 1/2" GAS F	-	Innesto / Receptacle NGV1-P30	RUBL1S.NIO	RUBL510
3 x 1/2" GAS M	T in ingresso / Input T connection	Tappi / Caps	RUBL3T.ITO	RUBL460
		Tappi + staffa / Caps and bracket	RUBL3T.IWO	RUBL480
	T in uscita / Output T connection	Tappi / Caps	RUBL3T.UO	RUBL490
		Tappi + staffa / Caps and bracket	RUBL3T.UWO	RUBL500

Volantino in Ottone / Brass Handwheel

Caratteristiche tecniche / Technical specifications

Materiale / Material	Acciaio / Steel
Temperatura di esercizio Working temperature	-40° C +120° C
Massima pressione di esercizio Max. working pressure	260 bar

MAND

Mandrino carica metano
CNG filling nozzle

metano

HP

CNG

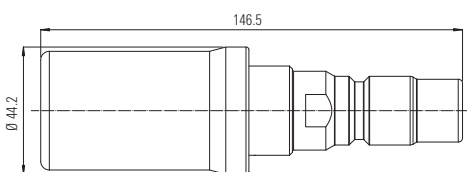
Codifica / Part n°
MAND IT. NG

TIPO / TYPE

IT: Carica metano Italia / CNG Italy filling nozzle

NG: Carica metano NGV1-P30 / NGV1-P30 CNG filling nozzle

PRESA POSTERIORE / BACK GRIP

NG: NGV1-P30

M: 1/4" GAS F

L: 1/4" 18 NPT

IT: Carica Italia / Italy filling

W: 9/16" 18 UNF

O: 1/4" GAS M

Alcune versioni disponibili / Some available part n°

Tipo Type	Presca posteriore Back grip	Codice Emer Emer part n°	Codice Emer obsoleto Former Emer part n°
Italia / Italy	1/4" GAS M	MANDIT.O	VAL14008
	1/4" 18 NPT	MANDIT.L	MAND413
	1/4" GAS F	MANDIT.M	MAND414
	NGV1-P30	MANDIT.NG	MAND419
NGV1-P30	1/4" 18 NPT	MANDNG.L	MAND420
	Italia / Italy	MANDNG.IT	MAND425
	1/4" GAS F	MANDNG.M	MAND426
	9/16" 18 UNF	MANDNG.W	MAND427